

RoHS

REV.	DESCRIPTION	DATE	DESIGN
A.	NEW DESIGN	2016-10-15	JERRY LI

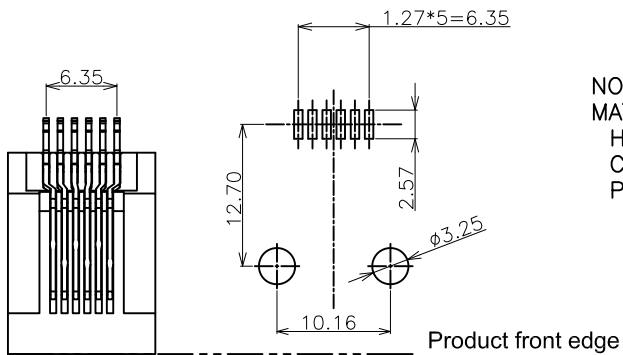
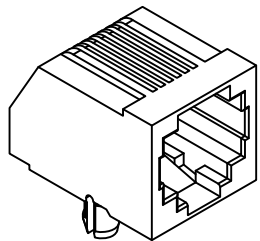

NOTES:
 MATERIALS
 HOUSING: HIGH TEMP. THERMOPLASTIC FLAMMABILITY RATING UL 94V-0.
 CONTACT: PHOSPHOR BRONZE.
 PLATING: GOLD PLATING OVER NICKEL IN CONTACT.
 TIN PLATING OVER NICKEL IN SOLDER AREA.
 NICKEL UNDERPLATING OVERALL.

RECOMMEND PCB LAYOUR
 ALL TOLERANCE ARE: $\pm 0.05\text{mm}$.

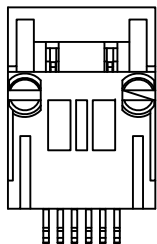
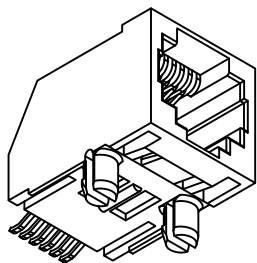
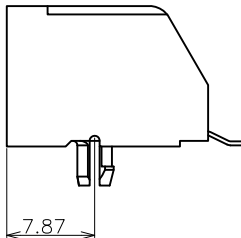
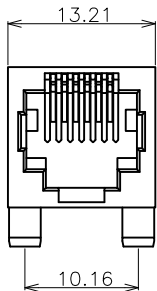
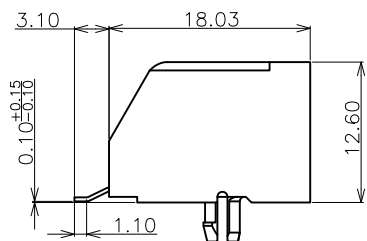

 UNIT: mm [Inch]	<h2 style="margin: 0;">Coorle Technology</h2>	
	DESIGN: Tina CHECKED: Jim APPROVED: Michael	PART NAME: PCB JACK SMD 6P6C PART NO. RJ255722-66GF-014 DRAW NO. CL-5722-03 SHEET NO. 1 OF 1
TOLERANCE: X.X ± 0.35 X.XX ± 0.25 X.XXX ± 0.15 Angle $\pm 3.0^\circ$	SCALE: 1:1 SIZE: A4	